

Update for  
**Lancaster County School District**  
**Multi-Purpose Buildings for**  
**Andrew Jackson, Buford and Lancaster**

**MOSELEY**ARCHITECTS

**Schematic Floor Plans and  
Site Plan Concept**



# Project Overview

## ■ Project Scope:

- Andrew Jackson Multi-Purpose / Fine Arts
  - 58,800 SF
  - 1,500 capacity in the MP Gym with Bleachers
  - MP Gym with Stage and Support Facilities, Walking Track
  - Art, Band, Chorus, Strings, Piano, Drama, Dance, Flex Classrooms
- Buford High School / Lancaster High School
  - 48,000 SF
  - 1,500 capacity in the MP Gym with Bleachers
  - MP Gym with Stage and Support Facilities, Walking Track
  - Flex Classrooms

## ■ Site Amenities:

- Parent Car, Student Car and Bus Site Circulation
- Parking



PROGRESS  
PRINT NOT  
FOR  
CONSTRUCTION

**ANDREW JACKSON MULTIPURPOSE BUILDING**

**Client Name**  
**Project Address**

## FLOOR PLANS

### A1.0.1

# Andrew Jackson MP Site Plan



working site plan  
11.1.2011

MOSELEYARCHITECTS

PROGRESS  
PRINT NOT  
FOR  
CONSTRUCTION

ANDREW JACKSON MULTIPURPOSE BUILDING

Client Name  
Project Address

ARCHITECTURAL  
SITE PLAN

A1.0.0



# Andrew Jackson GIS





# Buford Floor Plan

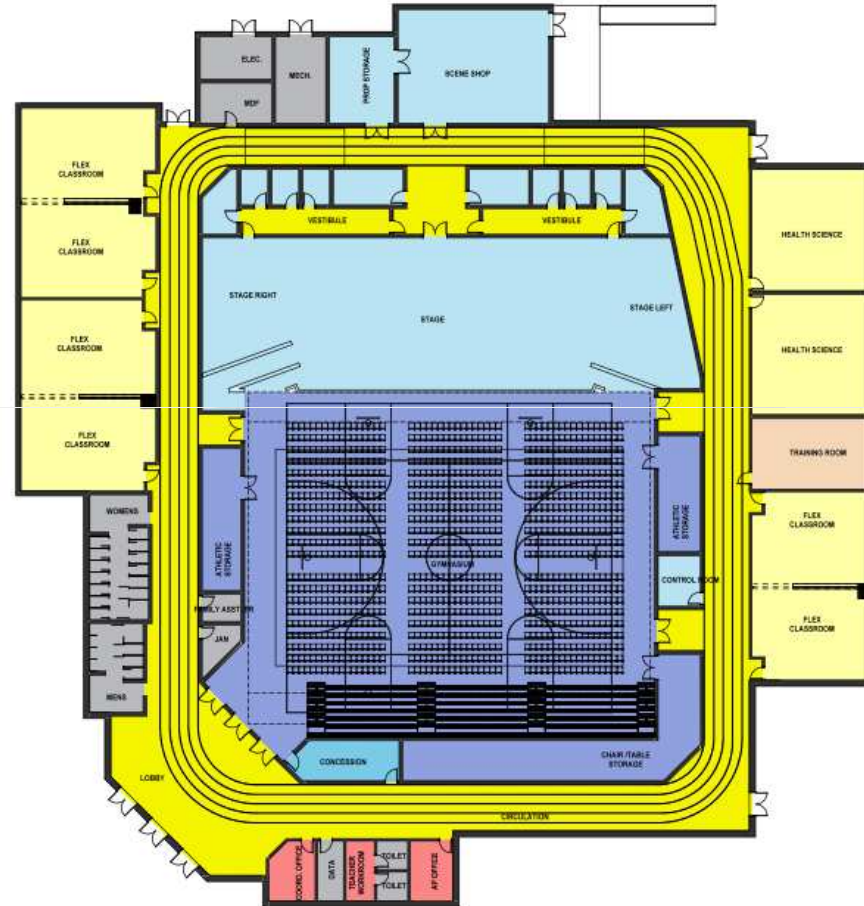

MOSELEYARCHITECTS

PROGRESS  
PRINT NOT  
FOR  
CONSTRUCTION

BUFORD HS Multi-Purpose Facility

Lancaster County School District

DATE	DESCRIPTION

FLOOR PLANS

A101



# Buford MP Site Plan

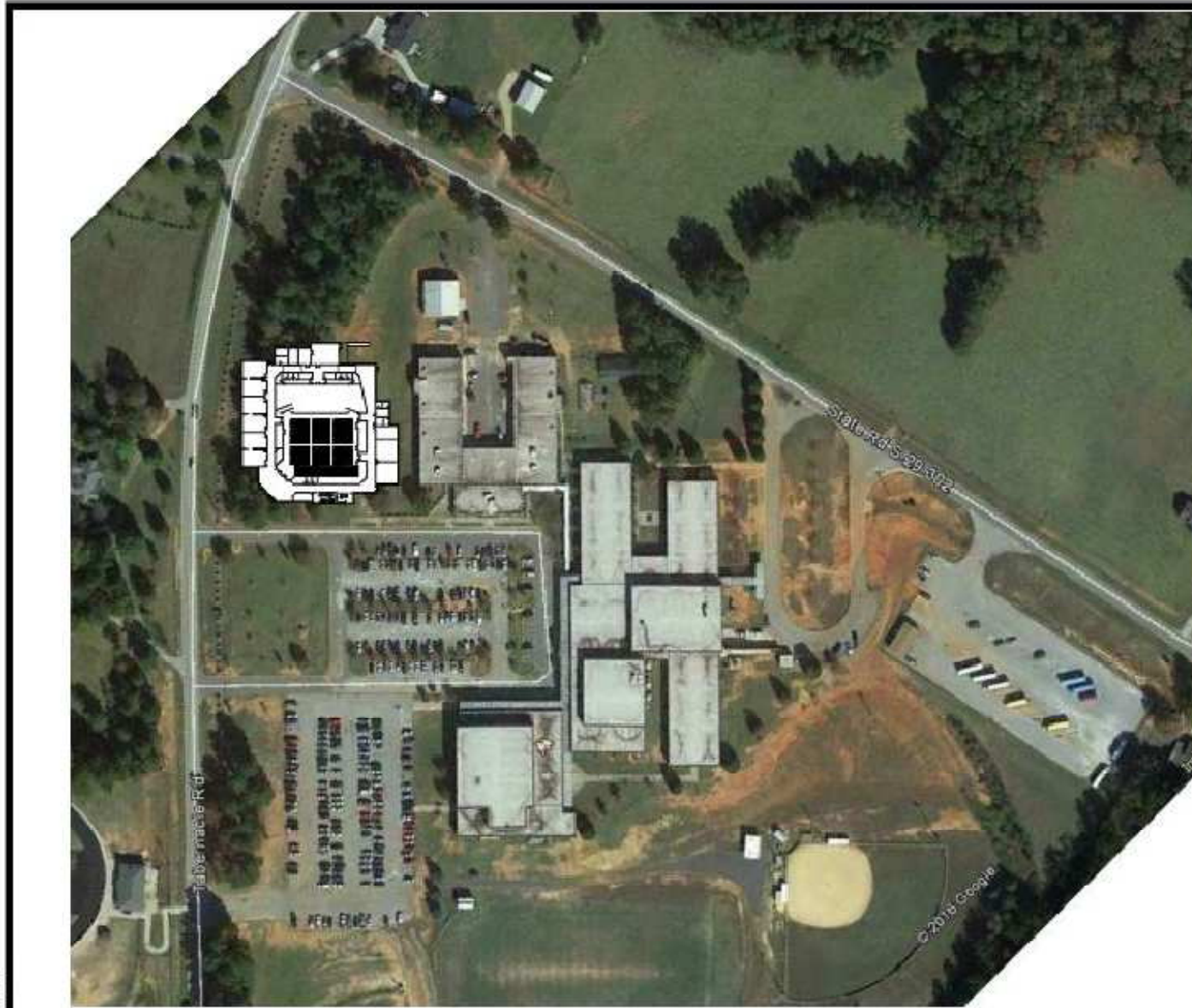

MOSELEYARCHITECTS

PROGRESS  
PRINT NOT  
FOR  
CONSTRUCTION

BUFORD HS Multi-Purpose Facility

Lancaster County School District

A110



# Buford GIS





## MOSELEYARCHITECTS

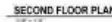

3000 Macomber St. #2001, St. Louis, MO 63103  
 Phone: (314) 744-7000 Fax: (314) 744-7000  
 E-mail: [info@stlucanet.com](mailto:info@stlucanet.com)

**LANCASTER HIGH SCHOOL MULTIPURPOSE  
BUILDING AND ADDITIONS-RENOVATIONS**  
LANCASTER COUNTY SCHOOL DISTRICT  
Project Address

姓名	张明
学号	123456789
性别	男
年龄	20
籍贯	江苏省南京市
民族	汉族
宗教信仰	无
政治面貌	共青团员
健康状况	良好
特长爱好	篮球、足球、游泳
自我评价	性格开朗，乐于助人，有较强的组织协调能力。

### FLOOR PLAN

**PREZ**

# Lancaster Lower Floor Plan

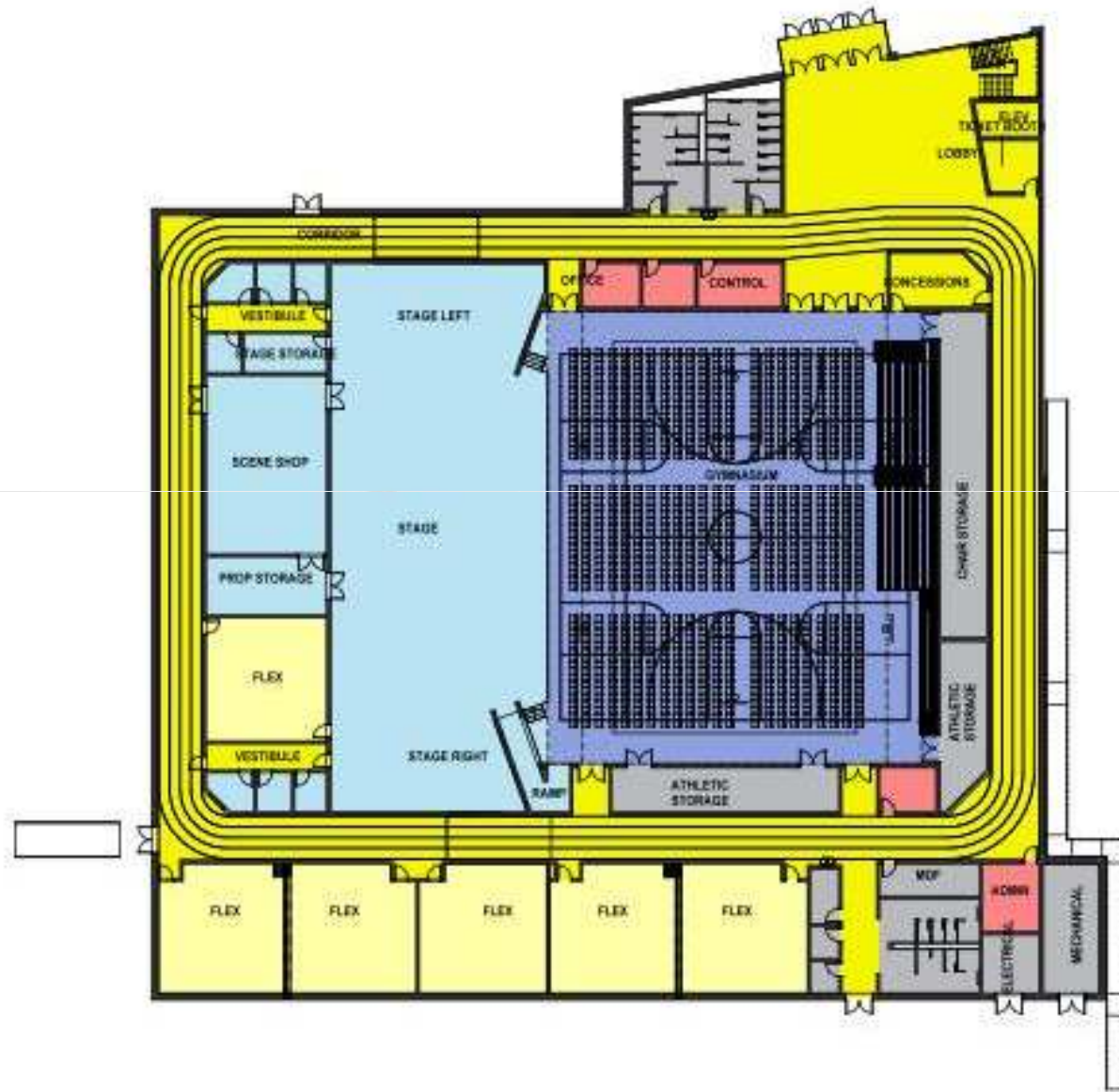



# Lancaster Upper Floor Plan

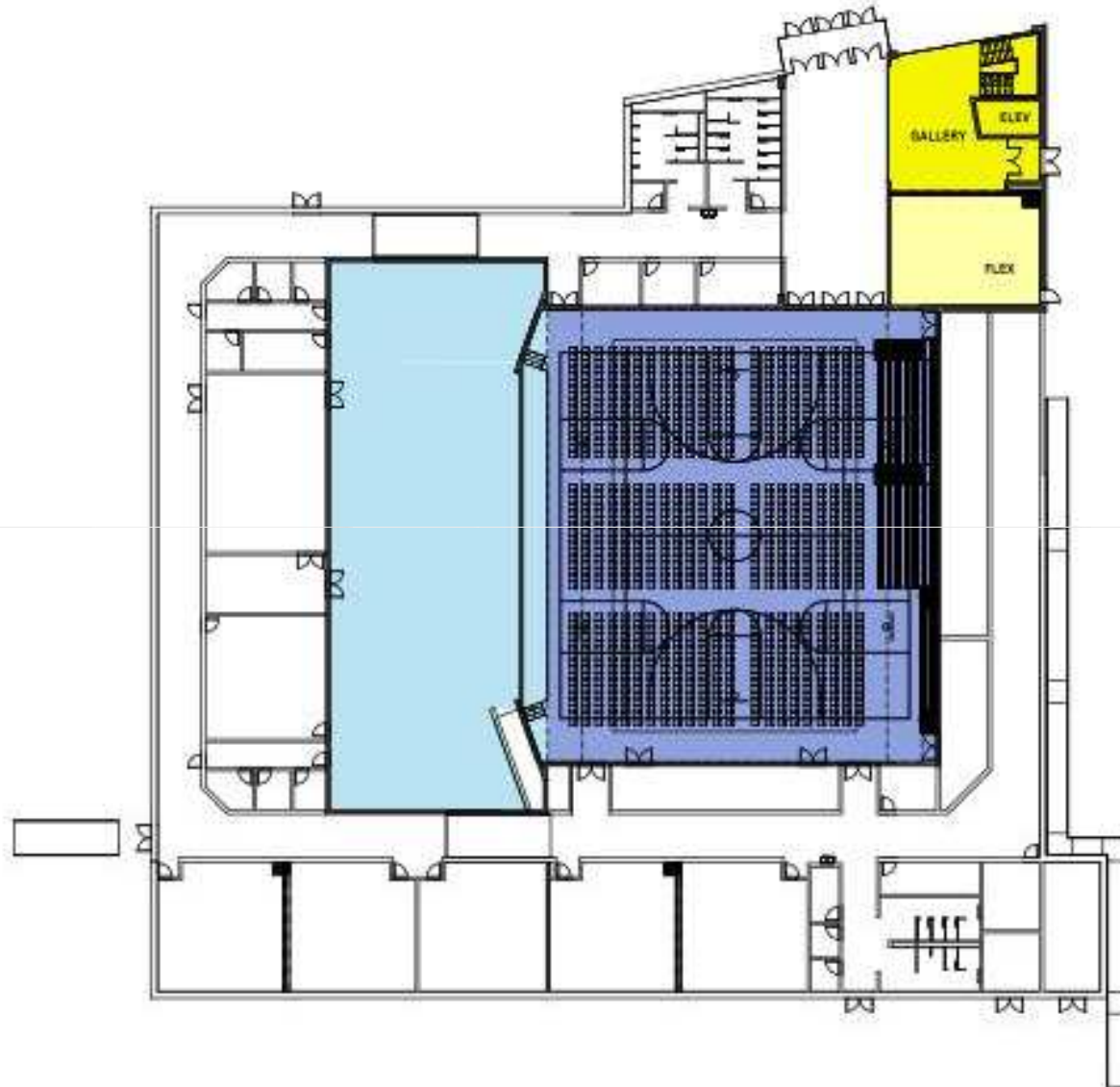

# Lancaster MP Site Plan

**MOSELEYARCHITECTS**PROGRESS  
PRINT NOT  
FOR  
CONSTRUCTION**LANCASTER HIGH SCHOOL MULTIPURPOSE  
BUILDING AND ADDITIONS-RENOVATIONS**  
LANCASTER COUNTY SCHOOL DISTRICT  
Project AddressARCHITECTURAL  
SITE PLAN

A1.0.0



# Lancaster GIS



LANCASTER HIGH SCHOOL  
GIS DATA MAP  
DATE: 07/19/16



**QUESTIONS???**

**THANK YOU !**